

KP16-NOTAUS

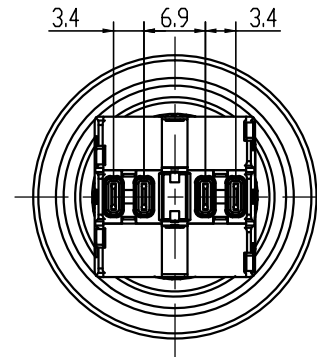

Rating / Schaltleistung: 5A 250VAC
 Contact Resistance / Kontaktwiderstand:
 50mΩ MAX(Initial value)
 Insulation Resistance / Isolationswiderstand: ≥100MΩ (500VDC)
 Dielectric Strength / Spannungsfestigkeit: 1000VAC rms.
 Electrical Life / Elektronische Lebensdauer: 50,000 Operations
 Operating Temperature / Betriebstemperatur: -25 °C - +55 °C
 Operating Pressure / Betätigungsdruck: 2 N ~ 5 N
 Operating Stroke / Hub: 1.5mm ~ 2.5mm
 Protection Grade / Schutzklasse: IP54
 Soldering / Löttemperatur: 300°C max. for 5 seconds
 Function / Funktion: OFF (ON)
 Material:
 Body / Gehäuse: PA66
 Nut: PA66
 Base: PBT
 Terminal / Anschluss: Gold Plated
 Contact: silver

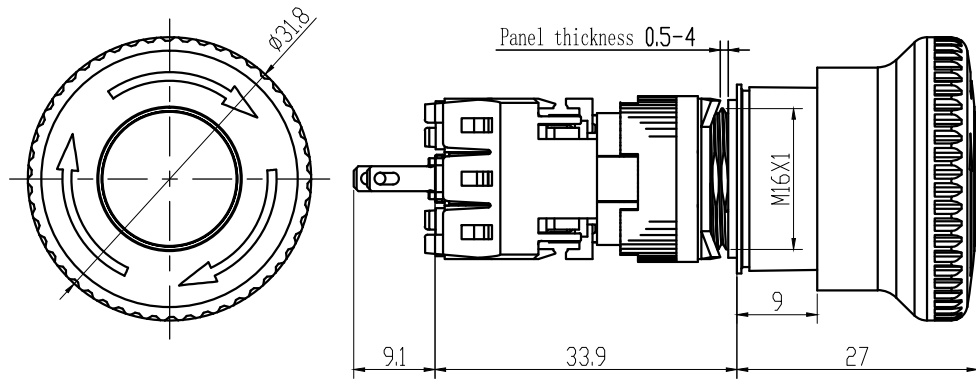
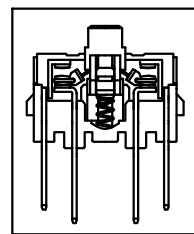
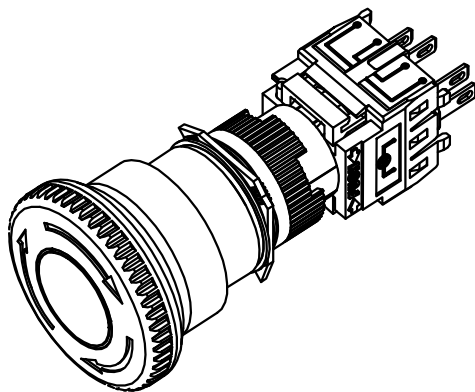

Kontaktart

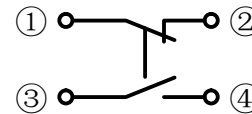

Schaltkreis

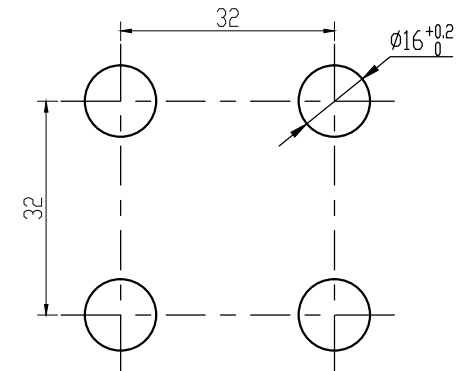

Install size / Bohrbild
